

## AS 176.3

### Aufsteck-Stromwandler



Stromwandler geeignet zum integrierten Einbau in die SlimLine-Schaltleisten der Größe XR1.

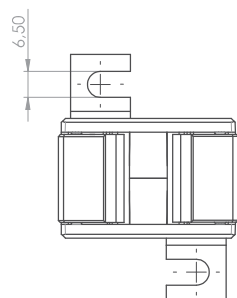
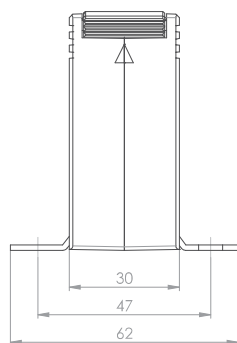
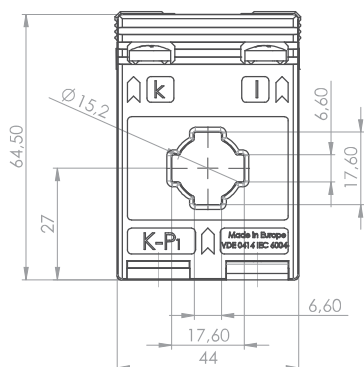

Schiene 1	17 x 6 mm
Rundleiter	15,2 mm
Baubreite	45 mm
Bauhöhe	65 mm
Bautiefe gesamt	30 mm



Primärstrom [A]	Bürde [VA]	Sekundärstrom [A] / Klasse			
		5 A Kl. 1 Best.-Nr.	5 A Kl. 0,5 Best.-Nr.	1 A Kl. 1 Best.-Nr.	1 A Kl. 0,5 Best.-Nr.
75	1,5	1001030006009		1001030206009	
80	1,5	1001030006010		1001030206010	
100	1		1001030005007		1001030205007
	2	1001030006001		1001030206001	
125	1,5		1001030005008		1001030205008
	2,5	1001030006002		1001030206002	
150	1,5	1001030006007	1001030005001	1001030206007	1001030205001
	2,5	1001030006003	1001030005006	1001030206003	1001030205006
160	2,5	1001030006004	1001030005004	1001030206004	1001030205004
200	2,5	1001030006005	1001030005002	1001030206005	1001030205002
250	2,5	1001030006008	1001030005003	1001030206008	1001030205003
	3,75	1001030006006	1001030005005	1001030206006	1001030205005

		Best.-Nr.
	Schnappbefestigung Form E	10055013
	Plombierplatte	-

# ASK 176.3

## Aufsteck-Stromwandler



- Schiene 1            17 x 6 mm
- Rundleiter           15,2 mm
- Baubreite            45 mm
- Bauhöhe              65 mm
- Bautiefe gesamt    46 mm

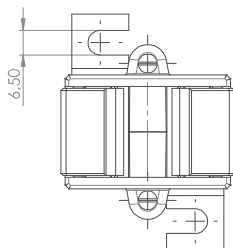
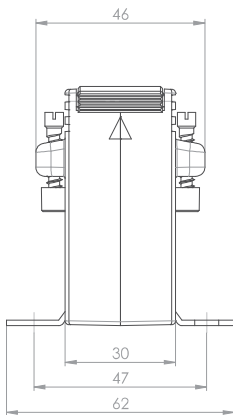
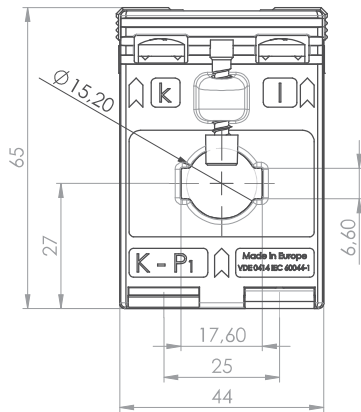

Primärstrom [A]	Bürde [VA]	Sekundärstrom [A] / Klasse			
		5 A Kl. 1 Best.-Nr.	5 A Kl. 0,5 Best.-Nr.	1 A Kl. 1 Best.-Nr.	1 A Kl. 0,5 Best.-Nr.
75	1,5	1001020006009		1001020206009	
80	1,5	1001020006010		1001020206010	
100	1		1001020005007		1001020205007
	2	1001020006001		1001020206001	
125	1,5		1001020005008		1001020205008
	2,5	1001020006002		1001020206002	
150	1,5	1001020006007	1001020005001	1001020206007	1001020205001
	2,5	1001020006003	1001020005006	1001020206003	1001020205006
160	2,5	1001020006004	1001020005004	1001020206004	1001020205004
200	2,5	1001020006005	1001020005002	1001020206005	1001020205002
250	2,5	1001020006008	1001020005003	1001020206008	1001020205003
	3,75	1001020006006		1001020206006	

		Best.-Nr.
	Schnappbefestigung Form E	10055013
	Plombierplatte	-